



**Invitation to  
FIS Nordic Combined World Cup in  
LILLEHAMMER (NOR)**

**Dear Ski Friends!**

We hereby invite all members of the International Ski Federation to participate in the FIS World Cup Nordic in Lillehammer 6<sup>th</sup> -8<sup>th</sup> December 2024.

**We look forward to seeing all of you in Lillehammer!**

Kind Regards,  
Lillehammer Olympiapark AS,  
Organising Committee WC  
<https://www.wclhmr.com/en>

**Venues:** FIS World Cup will be held in Lysgårdsbakkene Ski Jumping Arena and at Birkebeineren Ski Stadium.

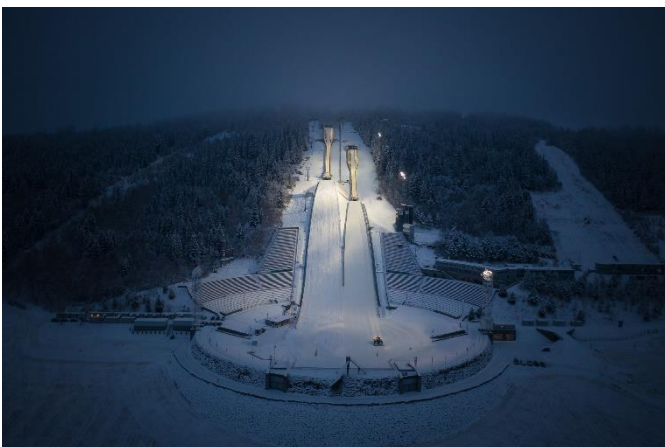



## FIS Officials

FIS Race Director	Lasse Ottesen
FIS Race Director Assistant	Jan Rune Grave
FIS Coordinator / Equipment Control	Guntram Kraus (M)
FIS Equipment Control	Kerstin Löscher (W)

FIS Technical Delegate	Matjia Stegnar
FIS Technical Delegate Ass.	Jana Koziskoca
FIS Technical Delegate Nat.	Rune Sørli

Judges:	Jørn Larsen (NOR)
	Takashi Kumagai (JPN)
	Karl Holz (AUT)
	Angelika Gobel (GER)
	Miha Sever (SLO)

## OC Contacts

Position	Name	Phone	Email
President, LOC	Per Olav Andersen	+47 91886082	per.olav.andersen@olympiaparken.no
Project manager	Mikko Kokslie	+47 977 93 788	Mikko.kokslie@olympiaparken.no
Chief of Competition	Linda Svendsrud	+47 959 49 294	Svendsrud.linda@outlook.com
Ass Chief of Competition W	Sara Nordsveen	+47 95496548	saranordsveen@gmail.com
Ass Chief of Competition M	Per Tommy Enger	+47 40400105	pte@renablikk.no
Venue Manager CC	TBA		
Venue Manager SJ	Per Otto Bergersen	+47 90940441	Per Otto Bergersen
Chief of media	Stein B. Olsen	+47 97718106	steinb@lillehammer.com
Event secretary	Bente Laugen	+47 48074467	wcnordic@olympiaparken.no
Accommodation	Bente Laugen	+47 48074467	accommodation@worldcuplillehammer.no
Accreditation	Camilla Jordheim	+47 45276647	accreditation@olympiaparken.no
Transport OC busses	Lars Erik Soensteli	+47 91638609	lars.erik.sonsteli@boreal.no
Transport local cars	Geir Olaf Oterholt	+47 90901015	geir@bluesfest.no
Finances	Silje B. Solbakken	+47 47620321	silje.solbakken@olympiaparken.no
Wax cabins CC	Odd Magne Tuterud	+47 95487518	odd.magne.tuterud@oyer.kommune.no
Wax cabins SJ	Roar Olsen	+47 91170733	roar.olsen@olympiaparken.no
Medical Service	Frøydis Nerموen	+47 99735468	froydis.nerموen@gmail.no





## Program

### Tuesday 03.12

- Open course, free training
- SJ Hill free training from 09:00 - 12:30 + 16:00 - 20:00 (TBC)

### Wednesday 04.12

- Open course, free training
- SJ Hill free training from 09:00 - 12:30 + 16:30 - 20:00 (TBC)

### Thursday 05.12

- 10:00 TCM NC W and M (Scandic Lillehammer Hotel)
- 12:00 Official training NC CC
- 17:00 Official training HS98 W (2 rounds)
- 18:30 PCR HS98 W

### Friday 06.12

- 08:30 Official training M (2 rounds)
- 10:00 PCR HS98 M
- 11:10 Trial Round HS98 W
- 11:50: Competition start HS98 W
- 14:30: Ind Gundersen CC 5km W

### Saturday 07.12

- 08:40 Trial Round HS98 W
- 09:30: Competition start HS98 W
- 10:20: Competition start HS98 M
- 13:45: Ind Gundersen CC 5km W
- 14:30: Ind Gundersen CC 10km M

### Sunday 08.12

- 10:00 Official training HS 140 M
- 11.15 Competition start HS 140 M
- 14:00 NC IC 7.5km M

A schedule for free training times (SJ) will be made for all nations. Training request can be sent to: [astrid.riise@olympiaparken.no](mailto:astrid.riise@olympiaparken.no).





## OC offices

Race office CC: Birkebeineren Cross Country Stadium  
Race office SJ: Lysgårdsbakkene Ski Jumping Hill  
Event office: Scandic Lillehammer Hotel

All times to be published in the FIS event calendar.

## Accreditation

The accreditation cards will be handed out at the event office at Scandic Lillehammer Hotel. Please note that the accreditations will be approved according to the registrations in the FIS Entry. Those who have the FIS season accreditation can use this instead of the local accreditation.

Those who don't register through the FIS online entry system need to apply for accreditation. For the application form or other questions regarding accreditation please contact [accreditation@olympiaparken.no](mailto:accreditation@olympiaparken.no)

## Accommodation

The OC offers the following accommodation (full board included) for athletes and staff:  
Three star hotel [Birkebeineren Hotel & Apartments](#)



Address: Birkebeinervegen 24, 2618 Lillehammer

Please note that this hotel also offers apartments.





### Prices and rules:

- Booking according to the FIS Rules via FIS Online registration system: [https://www.fis-ski.com/DB/?authentication\\_page=signin](https://www.fis-ski.com/DB/?authentication_page=signin)
- The OC will cover accommodation costs according to the FIS World Cup rules
- The price for accommodation outside of the quota or for additional nights is CHF 125 per person in a double room or apartment (minimum number of persons occurs). The price for additional single rooms is CHF 160.
- In case of extra single rooms inside the quota the cost difference between single and double room must be paid
- For NCM: For nations with starting quota 4 or more the OC will cover two single rooms

FIS Entry deadlines

Preliminary entries: 25/10/2024

Entries: 28/11/2024

### Cancellation rules and fees:

Please see World Cup Rules article 6.2.1 for W and 6.1.2 for M

- Cancellation fee between 8 days and until the end of the events: 100% cancellation fee
- For cancellations of more than what is stated in the rules above the OC will charge a 100% cancellation fee

### Official transport and shuttle

Official transport:

- Official airport: Oslo Airport Gardermoen
- For OC transportation, please fill in your request through the FIS online registration system: [https://www.fis-ski.com/DB/?authentication\\_page=signin](https://www.fis-ski.com/DB/?authentication_page=signin)
- There will be a limited number of OC departures from/to the airport.

Alternative transportation (if no OC bus):

- Train: Direct train (approx one departure every hour, except for in the night). Please see the schedule/order here: <https://www.vy.no/en>. Choose Oslo Lufthavn (the airport) to Lillehammer. Alternatively buy the ticket at the airport/station or on board the train.





Shuttle to the venues:

- There will be shuttle service between the hotel and the venues. For shuttle times see the transportation desk at your hotel reception or at the event office at Scandic Lillehammer Hotel.

### **Reimbursement for FIS Officials**

Carrying costs/Reimbursement:

Expenses sheets must be sent to [silje.solbakken@olympiaparken.no](mailto:silje.solbakken@olympiaparken.no). Payments will be done by bank transfer.

### **Travel money and payment**

- Travel money will be deducted from accommodation above quota and paid by bank transfer. Please send us updated bank information to [silje.solbakken@olympiaparken.no](mailto:silje.solbakken@olympiaparken.no)
- Accommodation costs above quota: Teams will pay directly in the event office at Scandic Lillehammer Hotel. Only credit cards will be accepted.
- In case you are not able to pay by card, please send us your invoice information in advance.
- For teams that already know that all their accommodation is inside the quota, please send us updated bank information.

### **Prize money payment**

Prize Money will be paid by bank transfer to the athletes after the event. The prize money is regulated by the FIS World Cup Rules. Receipts will be provided to the athlete electronically and a copy transmitted to FIS.

Remember to upload bank info using the FIS Athlete Registration module in the FIS member section. Responsible for prize money: [hedda.hoel@skiforbundet.no](mailto:hedda.hoel@skiforbundet.no)





## Income tax information for prize money

- Income tax of European citizens is 15%
- Income tax of non-European citizens is 15% (USA 0%)  
*Tax will be deducted by the OC according to the Norwegian Foreign Artist Taxation Act, and taxes will be paid by the OC according to the regular tax legislation in Norway.*

## Waxing facilities

- Wax cabins are available from 02/12/2024 at 12:00.
- The keys to the cabins are available at the wax building office (CC venue) and at the lift station (SJ venue).
- Keys return to the wax building office (CC) / lift station (SJ) on the day of departure.
- Waxing trucks: teams arriving with trucks have to inform the OC before the preliminary deadline
- Wax cabins for SRS companies according to World Cup rules. The companies must communicate to the OC their requests (parking size, power supply, etc.).

## Team Catering

Costs for lunch service at venue is CHF 10 per person for those out of quota or for those who haven't ordered and paid full board via the Organising Committee. Opening hours to be announced at TCM.

## Regulations of radio equipment/radio frequencies

The import, export and the operation of radio equipment in Norway is regulated by national law. Permits for the use of radio transmission equipment must be requested according to national specifications.

For information please see: <https://www.nkom.no/english/frequency-licences>

Please fill in the form '[Application for temporary use of radio equipment in Norway](#)' and return it to [firmapost@nkom.no](mailto:firmapost@nkom.no):

Deadline: as soon as possible.





## **Doping control**

According to FIS standards and rules.

## **FIS Licence**

To participate in FIS events all athletes must possess a valid FIS Code.

## **Insurance**

All athletes need the insurance arranged by their NSA. LOC is not responsible for any injuries of the athletes neither for the damage or lost property.

## **Regulations of Visa**

Remember that citizens of some countries will need a visa for visiting Norway. Please check with your embassy if you need a visa for Norway.

If you need an official letter of invitation from the OC, please send a request to: [wcnordic@olympiaparken.no](mailto:wcnordic@olympiaparken.no). Be sure to send names and what kind of information you need to get accepted to travel to Norway.

## **Truck driving and routes**

Special permissions for truck driving (Sunday- and night, other days with special regulations)

- There is no need for a special permission for truck driving on Norwegian roads. No special rules and regulations, except for the normal Norwegian weather and snow conditions and the need of snow tires.

Special advice for the route and roads







- From the previous World Cup stage to Lillehammer: no special comments.

### **Medical Service**

- In case you have an emergency, you can call the following number: 113
- Medical facilities at
  - the venue: + 47 997 35 468
  - hospital nearby: +47 915 06 200



## Arena Maps

### Lysgaardsbakkene Ski Jumping Arena

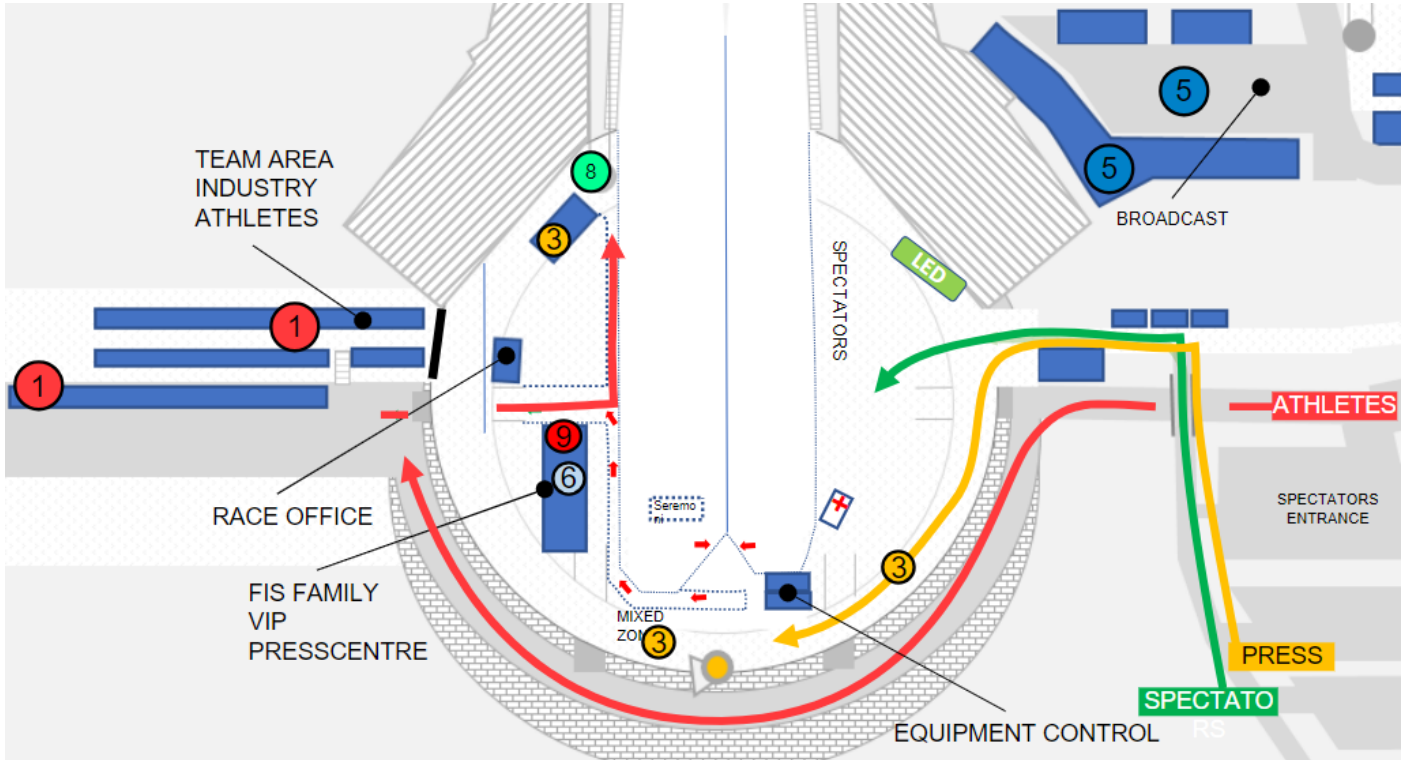



## Birkebeineren Ski Stadium

TBA

Updated course maps on website: <https://www.wclhmr.com/en> (TBA)

